

Pedestal Installation Overview

A Short overview of the various pedestal installations

[mm]
in

Installation:

1. Drill hole in dry concrete
2. Insert anchor bolt
3. Place pedestal
4. Place Washers, thread nuts
5. Tighten Nuts

Installation:

1. Place bolts in wet cement (For added strength add rebar over L" bolts)
2. After cured, place pedestal
3. Install washers and nuts

Installation:

- Place pedestal in wet cement
25" Suggested. Make sure to connect 1/2" NPTF Conduit fitting if it is to be used.

CEMENT PAD SUGGESTIONS		
Plate Size	DIM-A	DIM-B
5x5	5"	5"
8x8	6"	6"
12x12	8"	8"

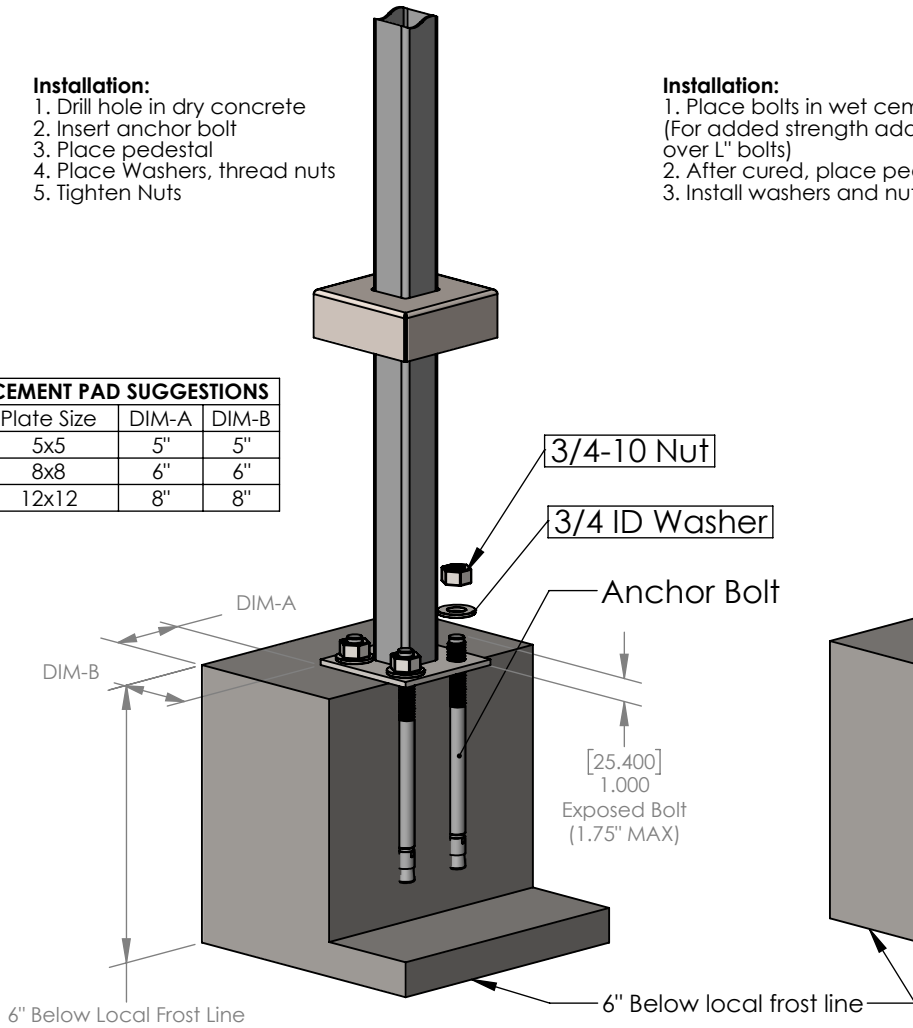

STUD-ANCHOR-KIT Installation
Best for existing concrete

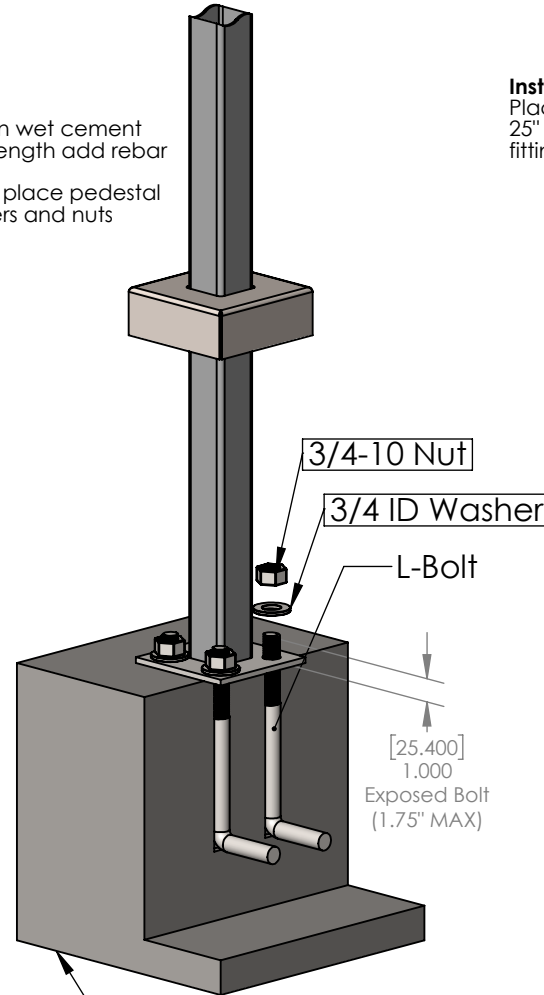

L-BOLT-KIT Installation
Best for new cement

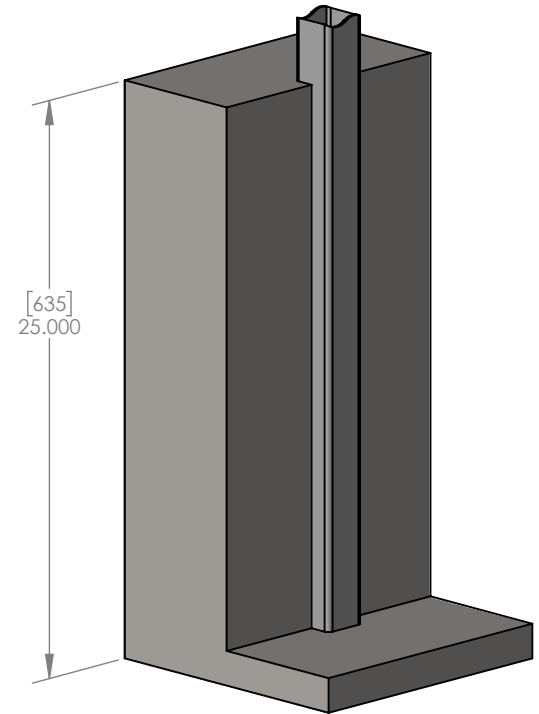

IN-GROUND Installation